

## Manhole cover without ventilation in the distribution frame

D400 - heavy traffic load

# Standard



Code	<b>KDG0K</b>
Material	<b>Concrete, Cast iron</b>
Weight	<b>328 kg</b>
Norm	<b>EN124-2</b>
Package	<b>5 ks/pal</b>
Load class	<b>Heavy traffic load</b>

cover without hinge, horizontal PUR shock-absorbing lining, without spring-loaded lid locking in frame

### COVER:

- | Cast iron without venting with anti-slip design.
- | Custom theme/logo option
- | Lid weight 63kg

### FRAME:

- | Distribution frame 1200mm without mounting for catcher
- | Frame height 200 mm
- | Use with BAR-V and BAR adjustment rings
- | Integrated PUR damping insert with high resistance
- | Three handling hinges

### OTHER:

- | The cover is supplied without surface treatment - painted variants can be ordered
- | Suitable for places with high traffic load
- | custom lid motif possible

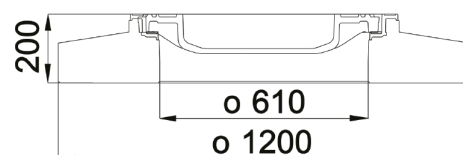
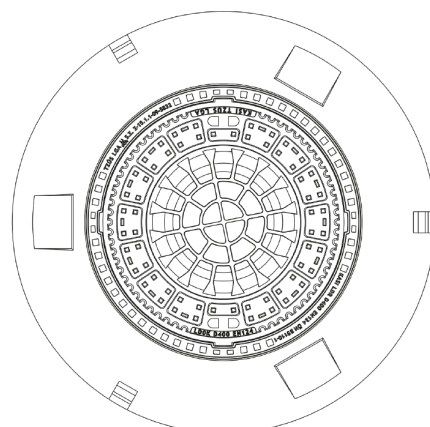
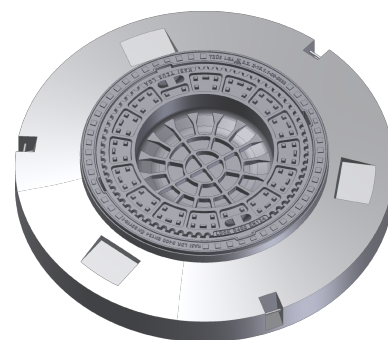

CUSTOMER  
SOLUTIONS



DAMPING INSERT

