

Manhole cover without ventilation in a cast-iron concrete frame

D400 - heavy traffic load

EUROPA 9



Code	KDB97XXXVMB
Material	Concrete, Cast iron
Weight	118 kg
Norm	EN124-2
Package	10 ks/pal
Load class	Heavy traffic load

Poklop EUROPA 9 s pantem, víko litina bez ventilace s otevřeným pantem tichý design, pružinové zajištění víka v rámu, D400, rám beton-litina v.160mm bez osazení pro lapač, horizontální a vertikální PUR tlumicí vložka na víku, logo VAK Mladá Boleslav

COVER:

- | Integrated KASI-PUR damping insert with high resistance
- | Hinge with possibility of removal from the frame
- | Custom logo motif on the lid
- | Safety lock at 90°
- | Lid weight 39kg

FRAME:

- | Cast-concrete frame without mounting for the trap
- | Frame height 160 mm
- | Machined frame contact surface to 0.1mm
- | Use with BAR-V and BAR adjustment rings

OTHER:

- | Option of screw locking
- | Suitable for places with high traffic load
- | Lid safety lock at 90°

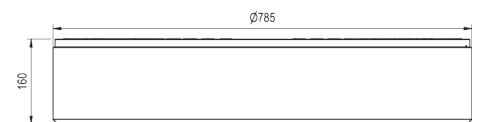

CUSTOMER SOLUTIONS



DAMPING INSERT



MAX. OPENING ANGLE

