

Inlet grille in cast iron frame

C250 - use max 0.5m into the roadway

Standard



Code	KM28
Material	Cast iron
Weight	58 kg
Norm	DIN1229, EN124-2
Package	24 ks/pal

Grate 300x500mm for street gullies.

COVER:

- Grille curved between ribs 35 mm
- Detachable connection of the grille to the frame

FRAME:

- Cast iron frame with mounting for trap
- frame height 150 mm

OTHER:

- There must be at least a 20mm high mortar joint between the frame and the top of the drain with a strength of at least 45MPa.

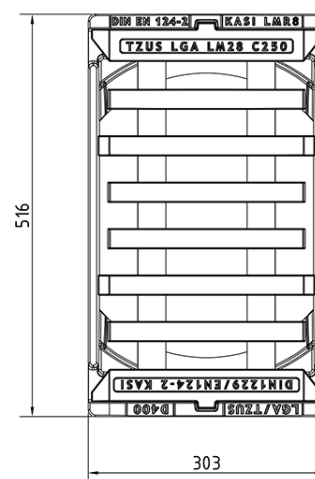
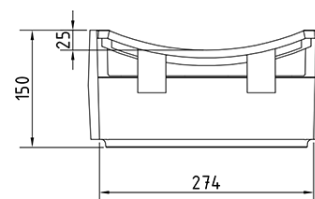

RAINWATER
DRAINAGE