

Inlet grille in cast iron frame

D400 - heavy traffic load

Standard



Code	KM08
Material	Cast iron
Weight	70 kg
Norm	DIN1229, EN124-2
Package	24 ks/pal

Grate 300x500mm for street gullies.

COVER:

- | Grille curved between ribs 35 mm
- | Detachable connection of the grille to the frame

FRAME:

- | Cast iron frame with mounting for trap
- | frame height 150 mm

OTHER:

- | There must be at least a 20mm high mortar joint between the frame and the top of the drain with a strength of at least 45MPa.

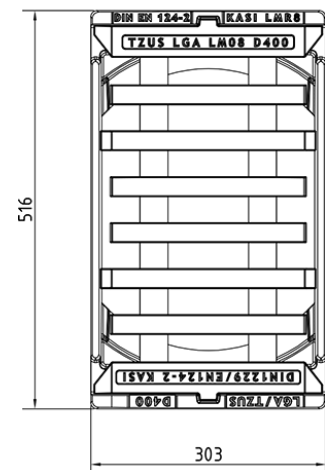
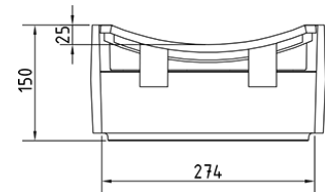

RAINWATER
DRAINAGE

